



# Arthroscopy

Puncture System acc. to Dr. Lehmann for the canine shoulder joint

## Innovation in small animal arthroscopy

Developed and tested at the Veterinary Faculty of Vienna, Austria

During recent years, as arthroscopy in small animals has developed, researchers realized the necessity of a specific puncture system to create an instrument portal in the larger joints. Due to the dense muscle mass in shoulder joints, creating a puncture for a working cannula is often quite difficult. If a clean puncture allowing access directly to the joint is not achieved the first time, the risk of a subsynovial oedema increases greatly, thus decreasing the time frame to complete the surgery with each failed puncture. The shoulder puncture system has been specifically designed

to help eliminate this risk. The system allows you to align your arthroscope accurately in the joint space. Simply attach the puncture system to the arthroscopic sheaths and maintain your arthroscopic vision in a parallel direction to the shoulder joint rim. At this point you will find the working triangulation portal in an ideal position. After a puncture is created with the desired trocar, simply replace the trocar with a working cannula and start working with your instruments.

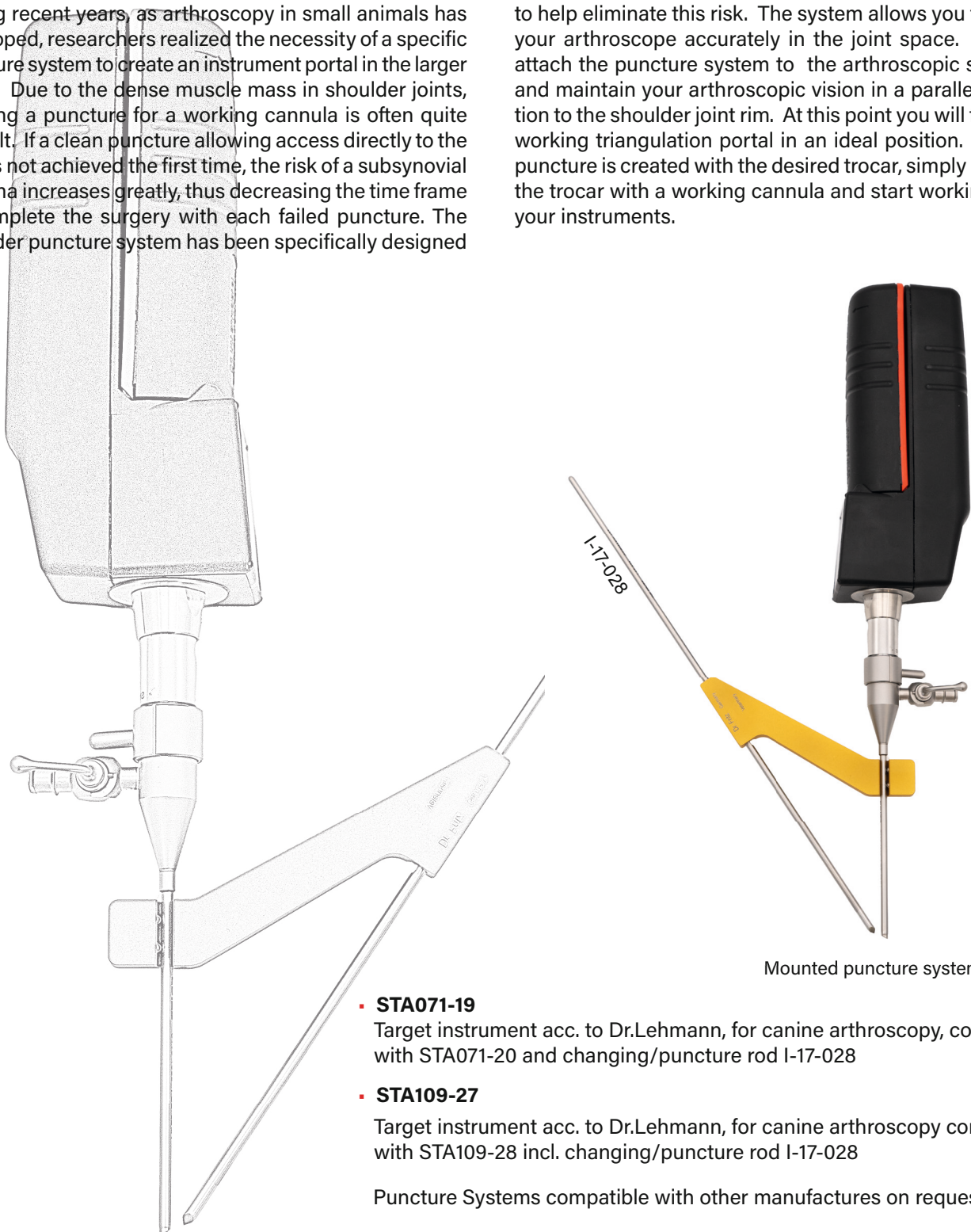

- **STA071-19**

Target instrument acc. to Dr. Lehmann, for canine arthroscopy, comp. with STA071-20 and changing/puncture rod I-17-028

- **STA109-27**

Target instrument acc. to Dr. Lehmann, for canine arthroscopy comp. with STA109-28 incl. changing/puncture rod I-17-028

Puncture Systems compatible with other manufactures on request.



# Arthroscopy

## Irrigation and Working Cannulas, Trocar Changing System acc. to VAN BREE

The trocar changing system acc. to VAN BREE allows the specific exchange of different working cannulas. Beginning with the smallest diameter, the surgeon can always change to a bigger diameter by using the changing rods. According to the different joints a so called „elbow set“ (working length 3,5-5 cm) and a „shoulder set“ (7-7,5 cm) is differentiated. In addition it is possible to change the working portal with the telescope portal using the changing rod. The color code system allows easy size differentiation.

### Set I-17-755

Working cannula set „**shoulder and elbow**“ acc. to van BREE consisting of:

- Set I-17-500
- Set I-17-700

Complete set



### Set I-17-500

Working cannula set „**elbow**“ acc. to van Bree, consisting of:

- **I-17-524**  
Working cannula incl. sharp obturator ID: 2,3mm WL 5,5cm, gold
- **I-17-528**  
Working cannula ID: 2,9mm WL 4,8cm, metal
- **I-17-535**  
Working cannula ID: 3,5mm WL 3,5cm, schwarz
- **I-17-024**  
Changing rod 2,3mm round / pointed, gold



I-17-024

### Set I-17-700

Working cannula set „**shoulder**“ acc. to van Bree, consisting of:

- **I-17-728**  
Working cannula incl. sharp obturator ID: 2,9mm WL 7,5cm, metal
- **I-17-735**  
Working cannula ID: 3,5mm WL 6,8cm, black
- **I-17-028**  
Changing rod 2,9mm round / pointed, metal

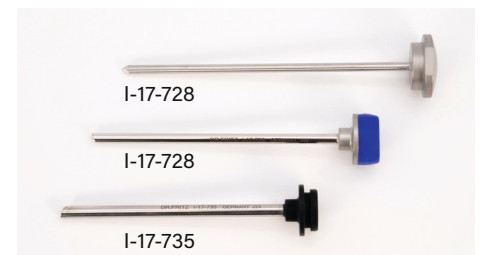

I-17-028

### I-17-535-G

Working cannula with thread ID:3,5mm, WL:3cm (can replace I-17-535)



### I-17-002

Sealing caps for small trocar cannulas opening: 2mm 5pcs.

### I-17-735-G

Working cannula with thread ID:3,5mm, WL:6,8cm (can replace I-17-735)





# Arthroscopy

## Hand instruments



Hand instruments with colour coding are easy to recognize and perfectly to use in small and in large joints according to the patient sizes.

- ✓ Easy handling
- ✓ Ergonomic design
- ✓ For universal use
- ✓ Suitable for Dr. Frizu working cannulas



### AR-17-03S

Bajonett knife 2,7mm, silicon handle, autoclavable



### AR-17-05S

Banana knife, 2,7mm, silicon handle, autoclavable



### AR-17-06S

Curette, small 2,7mm, silicon handle, autoclavable



### AR-17-07S

Ring curette, 2,7mm, silicon handle, autoclavable



### AR-17-09S

Hook probe, 2,2mm, silicon handle, autoclavable



### AR-17-11S

Smilie knife, 2,7mm, silicon handle, autoclavable



### AR-17-12S

Mikro picking knife, acc. to Dr. Beale, 2,7mm, silicon handle, autoclavable



### AR-17-19S

Hook knife, 2,7mm, Silicon handle, autoclavable





# Arthroscopy

## Hand instruments

### Elevator

#### AR-17-13

Special elevator, 2,7mm,  
with handle, metal



### Milling Drill acc. to VAN RYSEN & VAN BREE

The latest development allows cartilage and bone curettage even  
through the smallest working cannula

#### I-17-822

Milling drill for arthroscopy, acc.to van RYSEN  
D: 2,2mm, WL: 12cm  
with rotating handpiece, long lasting drill steel, dismantable  
Consisting of: handpiece (I-17-820) and milling drill (I-17-821)

Rotating handpiece

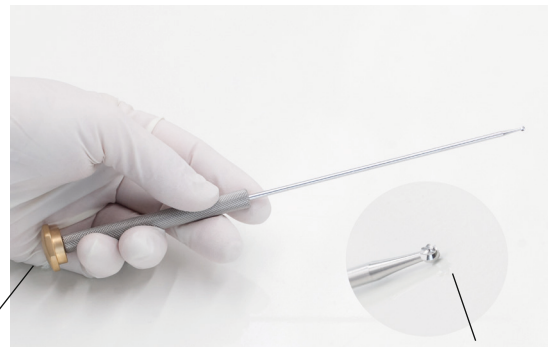

Changeable drill

### Instruments for high frequency

Mono-/Unipolar  
HF/RF cutting electrodes, the electric knife

#### HF-200-055

High frequency connecting cord comp. to arthroscopic  
cutting electrodes, handles length: 5 m,  
for units with 4 mm connector



#### HF-200-45

High frequency cutting electrode for  
arthroscopy, 45°, fine tip 4 mm connector, 12 cm



#### HF-200-90

High frequency cutting electrode for  
arthroscopy, 90°,  
heavy version 4 mm connector, 12 cm





# Arthroscopy

Punches, Biopsy Forceps, Rongeurs and Grasping Forceps

## 2mm Instruments

- **AS-17-521**  
Mini scissors - high performance -  
D: 2mm, WL:11cm

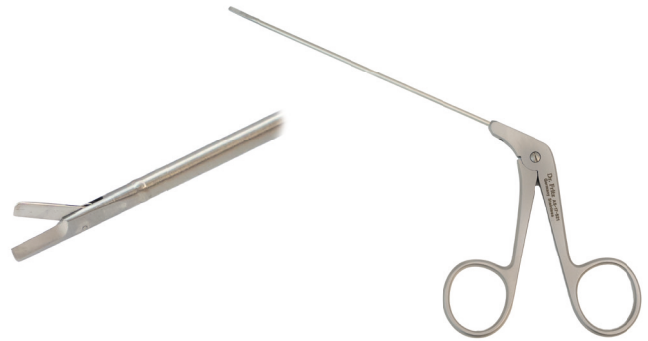

## 2,2/2,7 mm Instruments

- **AT-19-231**  
Mini-Rongeur - high performance -  
D: 2,2/2,7mm, WL:11cm  
Overstraining protection, cleaning connector



## 2,7 mm Instruments

- **AS-17-632**  
Universal rongeur and grasping forceps  
D: 2,7 mm, WL:12cm  
- with overstraining protection -



- **AS-17-641**  
Rongeur and biopsy forceps,  
D: 2,7 mm, WL: 12cm  
- with overstraining protection -



- **AS-17-672**  
Arthroscopic punch,  
D: 2,7 mm, WL:12cm  
- with overstraining protection -



- **AS-17-621**  
Arthroscopic punchh,  
D: 2,7 mm, NL:12cm



- **AS-17-662 - mit Sperre** -  
Alligator grasping forceps,  
D: 2,7 mm, WL:12cm  
- with overstraining protection -



Handle with ratchet  
ergonomic and  
small grip

- **Overstraining protected**
- **Wasp waisted design**
- **Long life span**

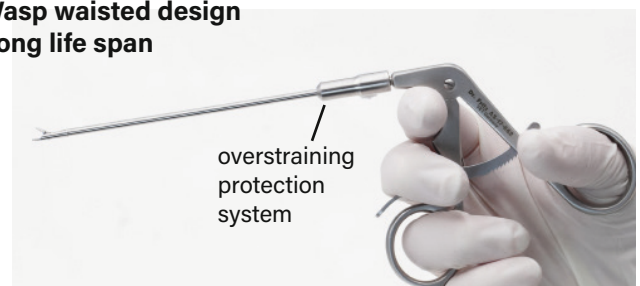



# Arthroscopy

Punches, Biopsy Forceps, Rongeurs and Grasping Forceps

## 3,4 mm Instruments

### AT-19-343

Maxi-Rongeur -high performance-  
D:3,4 mm,WL:12 cm, with overstraining protection,  
cleaning connector



### AS-17-762

Rongeur, universal & grasping  
D:3,4mm,WL:12cm,  
with overstraining protection



## 3,5 mm Instruments

### AY-19-463

Arthro grasper, grooves,  
D:3,5 mm, WL:10 cm,  
conical pointed, with maximum power  
U-shaped construction

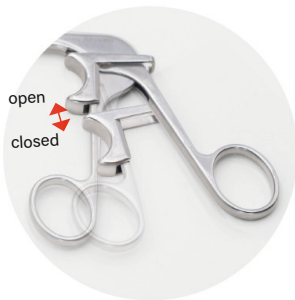

- ✓ Easy cleaning
- ✓ Fine and extremely strong
- ✓ Ergonomically adapted with lock

### AY-19-451

Arthro punch, straight,  
D:3,5 mm, W L:10 cm  
conical pointed, with maximum power cut  
U-shaped construction



## 4,0 mm Instruments

### AY-19-452

Arthro punch, bent upwards, D:4 mm, WL:10cm  
conical pointed, with maximum power cut  
U-shaped construction





# Arthroscopy

Fluid Supply System for Arthroscopy

## Manual fluid supply system

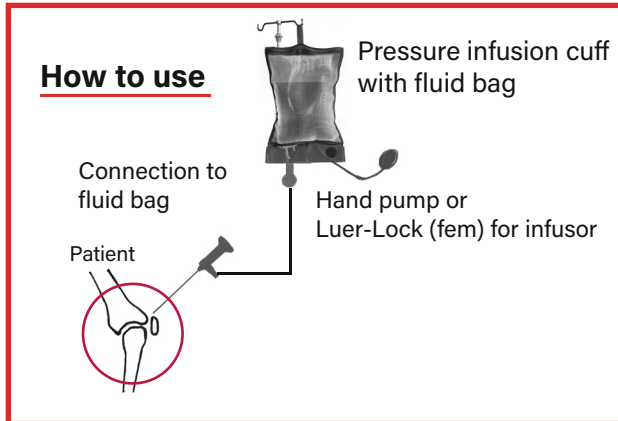

One of the cheapest options for liquid supply

### Pressure Infusion Cuffs



- **AR-08-100N Pressure infusion cuff** for 500-1000ml with manometer and hand pump reusable high quality manufacturing

▷ For high flow fluid supply, please use big infusion tubes

## Accessories



I-18-518

- **I-18-518 Egress cannula** with sharp trocar stopcock, ID: 2,7mm, WL: 7cm

### Connection: Fluid bag to arthroscope



AR-10-948

- **AR-10-948 Silicon tube** D: 6x2 mm, WL: 3 m, autoclavable, Luer-Lock (m), needle f. sterile bags/bottles, large inner diameter

- **X-7-20-10 Silicon spare tube** Silicon spare tube, 100cm, large inner diameter, size: 6x2mm, color: natur



AR-10-9

- **AR-10-9 Needle for infusion bottles/bags** ID: 4 mm, compatible to silicon tubes 3,5-5 mm
- **LLM-1258 Luer-Lock connector, male** 10 mm

**NEW**

# Shaver

**Cordless single use shaver system for arthroscopy**

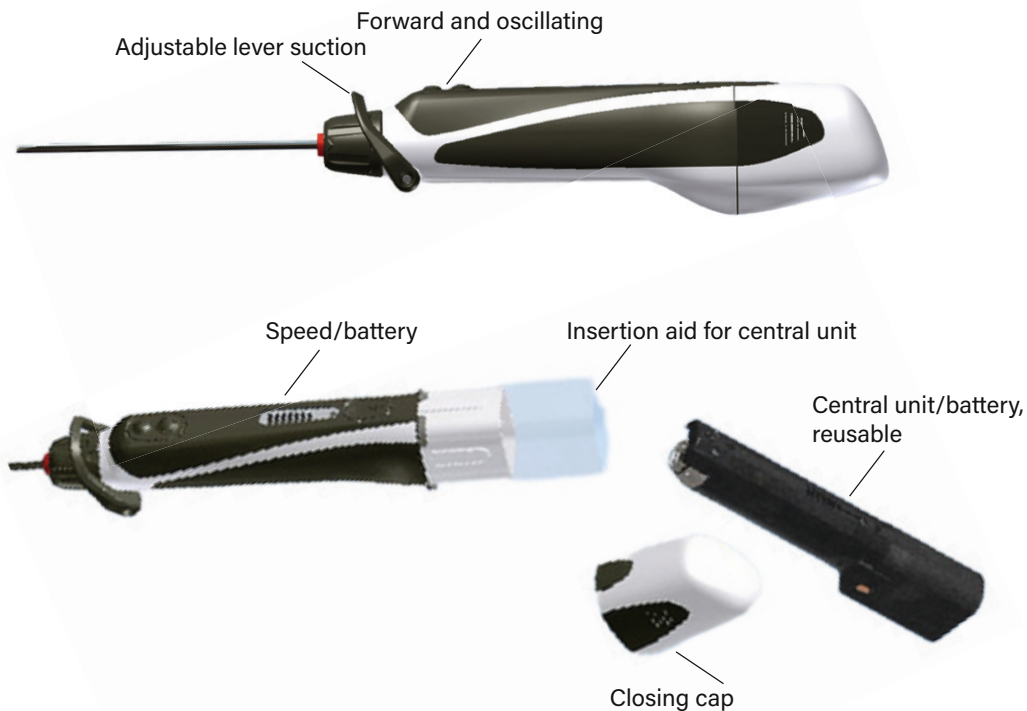

## ■ Starter set (SFR-205SET)

Set consistinf of:

- Central unit - motor (SFR-206M)
- Charging station (SFR-205B)
- Burr shaver Ø 4,5mm (SFR-104C)



## ■ SFR-206M Central unit - motor

The reusable central unit, the heart of the system, is equipped with state-of-the-art electronics and a rechargeable battery. It provides the surgeon with both standard and advanced features: a powerful brushless motor ensures optimal torque for all arthroscopic procedures, while the durable battery supports even the longest surgeries.

- 6000 rpm
- Approx. 40min. runnig time



## ■ SFR-205B Charging station

The charging station accommodates up to four central units, though the central units (motors) are not included with the charging station. When a central unit is inserted, it is checked by an intelligent control system. A display then indicates the battery's charge status.



**NEW**

# Shaver

**Cordless single use shaver system for arthroscopy**

## ■ Disposable shaver

- No preparation or sterilization required
- Ready for immediate use
- Integrated tube connection
- Minimum order quantity: 5 pieces

Sterile packaging

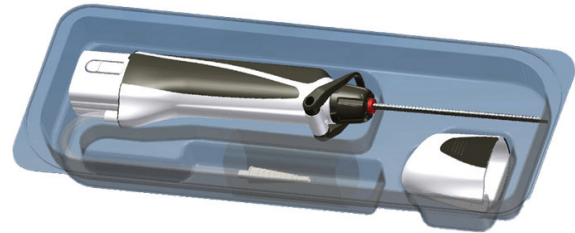

- Aggressive meniscus resection, fast removal of soft tissue during shoulder surgeries.
- Suitable for a combination of soft tissue and bone resection.

Ø	Item No.
3,5mm	SFR-103L
5,0mm	SFR-104L



- Versatile aggressive cutting blade:  
Ideal for extensive tissue removal.

Ø	Item No.
2,9mm	SFR-102N
5,0mm	SFR-104N



- Oval Burr:  
Fast bone resection.
- Suitable for subacromial decompression.

Ø	Item No.
4,5mm	SFR-104E



- Serrated inner blade and smooth outer blade for effective resection of meniscus, cartilage, and synovium.

Ø	Item No.
3,5mm	SFR-103P



- Ball Burr:  
Ideal for notchplasty and osteochondral cleaning.

Ø	Item No.
4,5mm	SFR-104C





# Arthroscopy

## Accessories

### ■ Camera Covers

DE-10-25

#### Camera Covers

disposable, 1 pcs, polyethylen, 1  
3x250 cm, minimal amount  
50 pcs



DE-10-25



### ■ Cleaning accessories

DE-5-17

**Cleaning brush**, small, 17 cm  
for tubes, ID:2-4 mm, autoclavable



DE-10-300

**Disinfection solution IP**  
for flexible and rigid endoscopes.  
manual and automated use,  
1-3% dilution, 5 litres



DE-10-425

#### Soak basin

for chemical solution  
disinfection, cons. of basin (perforated)  
tray & cover for basin, size: 42x16x9,5 cm





# Arthroscopy

## Accessories

### Video cart

Completely mounted

- ✓ 50cm unit size
- ✓ Camera fixation knob
- ✓ Drawer
- ✓ Ask for additional accessories

#### WV-54043 Video cart, H: 143 cm

size: 62x63 cm, completely mounted, basic version,  
color: grey, partly blue,  
\*\*drawer inbuilt  
\*\*fixation knob for video camera head  
\*\*specially rust protected  
max. weight: 150kg/330lbs

(Gastroscope bracket, fixation system. devices  
and monitor are separate accessory)



WV-54043

#### WV-53022 Video cart as above but height 110 cm (without pictures)

#### WV-45111 Video cart, H: 112 cm,

size: 54x58cm,  
completely mounted, basic version,  
drawer inbuilt with handle  
max. weight: 50kg/110lbs  
max. unit size: 45cm  
color: grey, partly blue,



WV-45111

### Accessories for Video cart

#### WV-99619 Fixation system for infusion bottles mounting set

#### WV-99618G Gastroscope mount for Dr. Fritz TG series inductive charging, with telescope rod

#### WV-01601 Fixation system for CO<sub>2</sub> bottles mounting set, comp.to video carts for 5-10 litre bottles, max OD: 14,5 c

#### WV-02851 Fixation system for CO<sub>2</sub> bottles mounting set, comp.to video carts for big bottles, max OD: 20,5 cm



WV-99618G